

Sampson County 1 - 4

PROJECT REFERENCE NO.	SHEET NO.
2021CPT.03.27.10821, ETC.	1

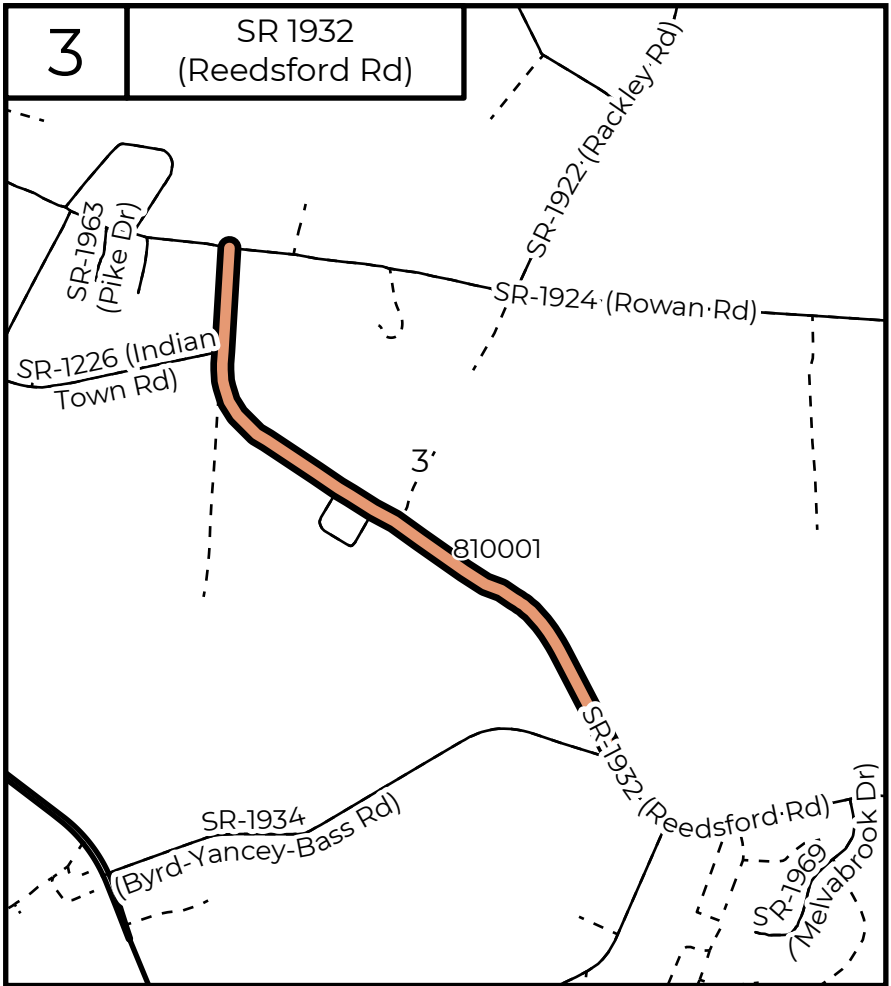

Sampson County 4 - 8

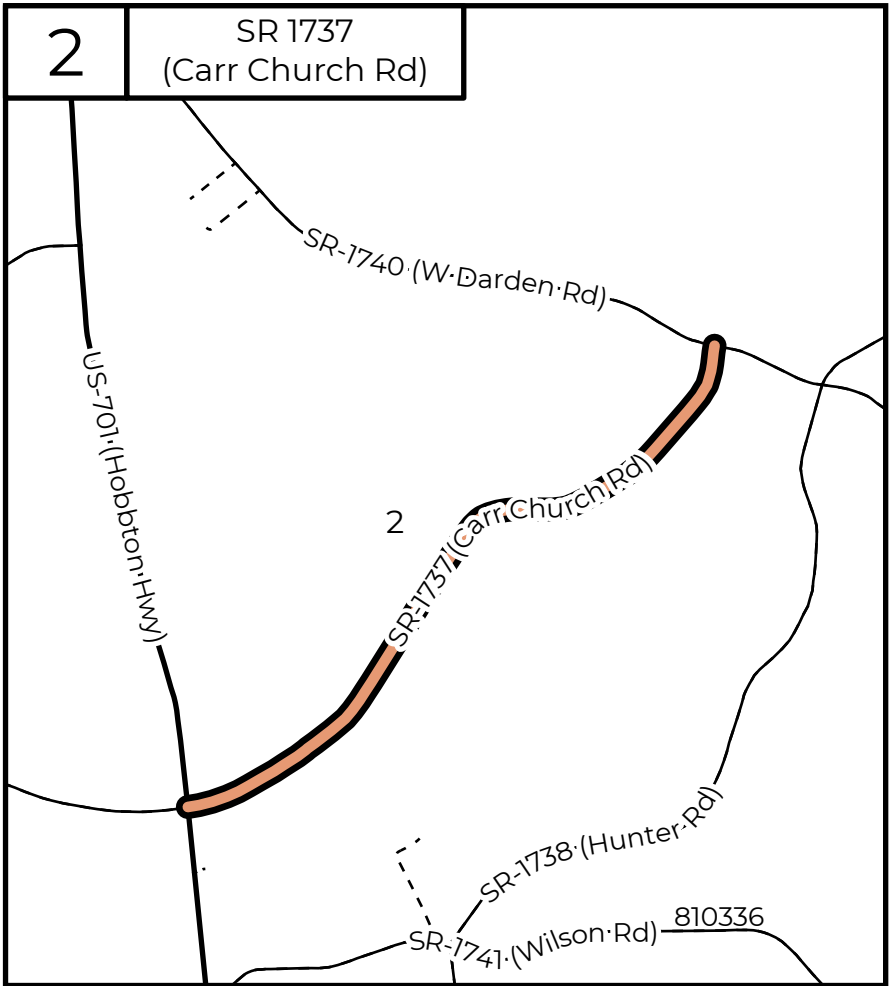
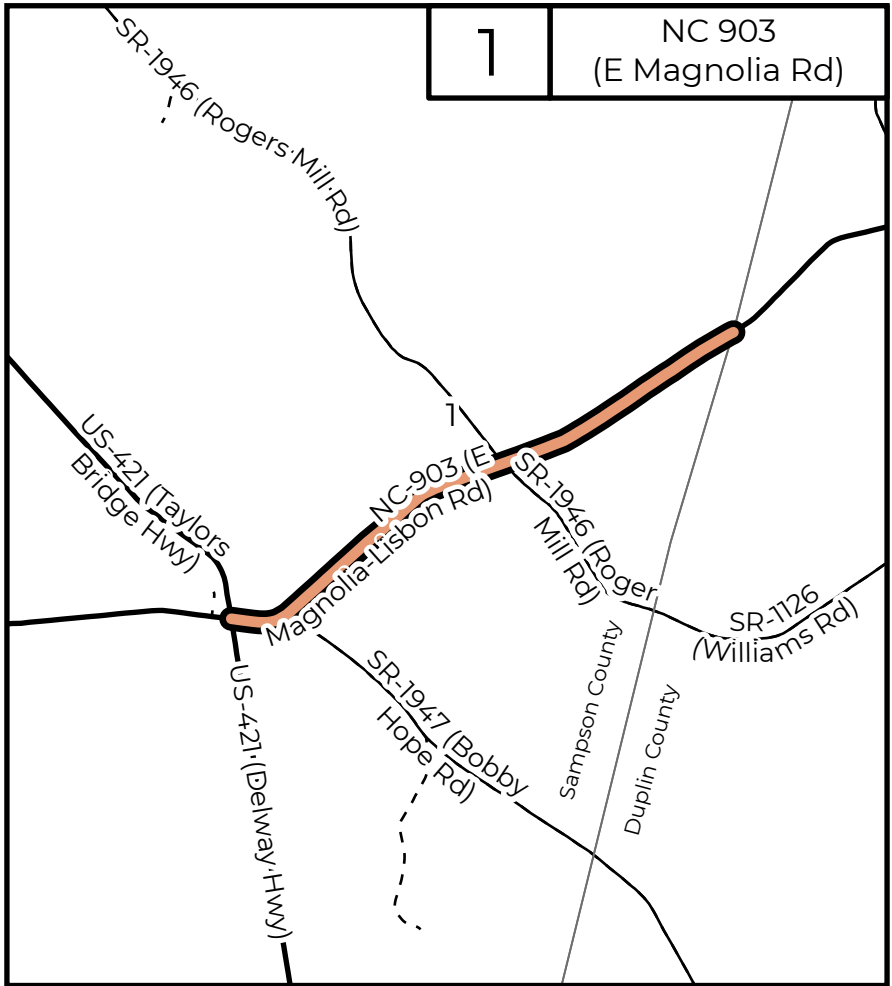
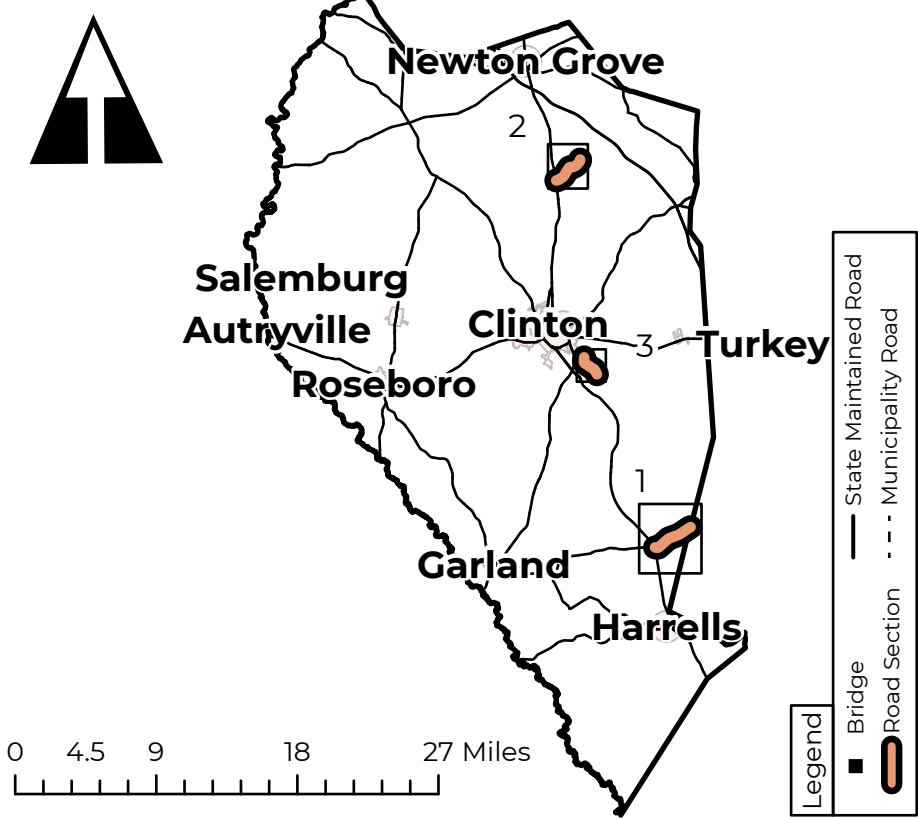
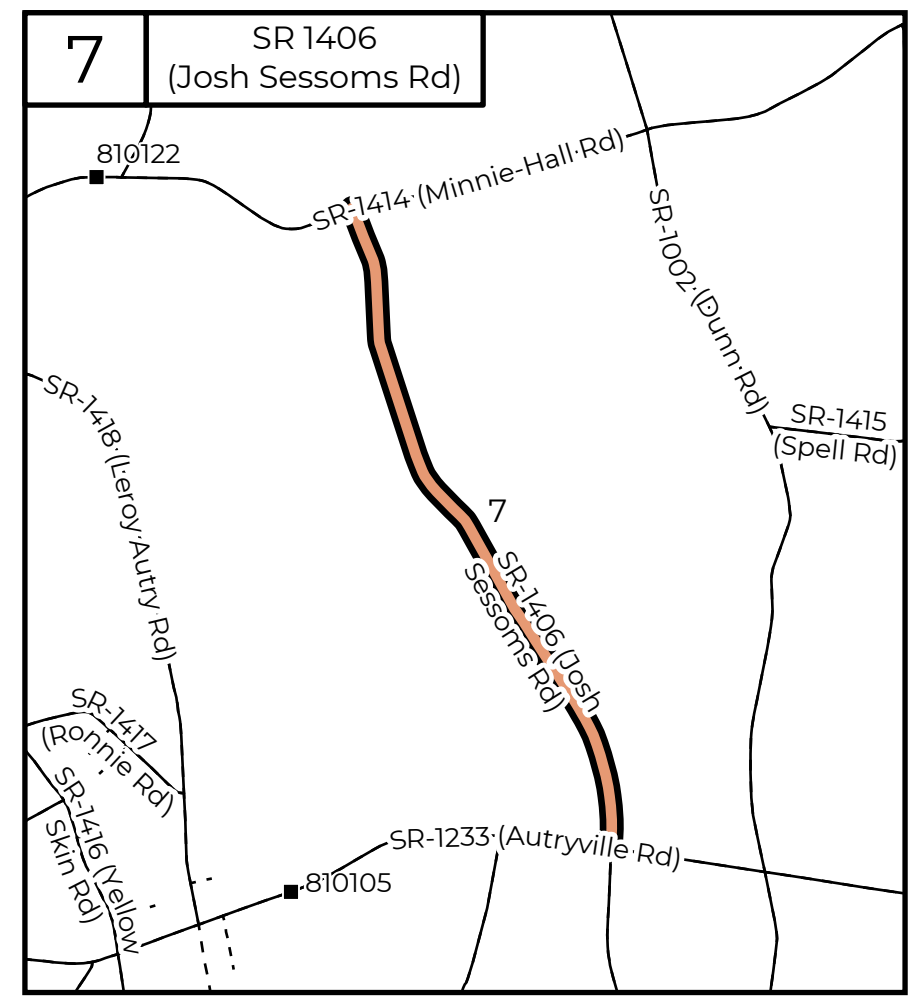
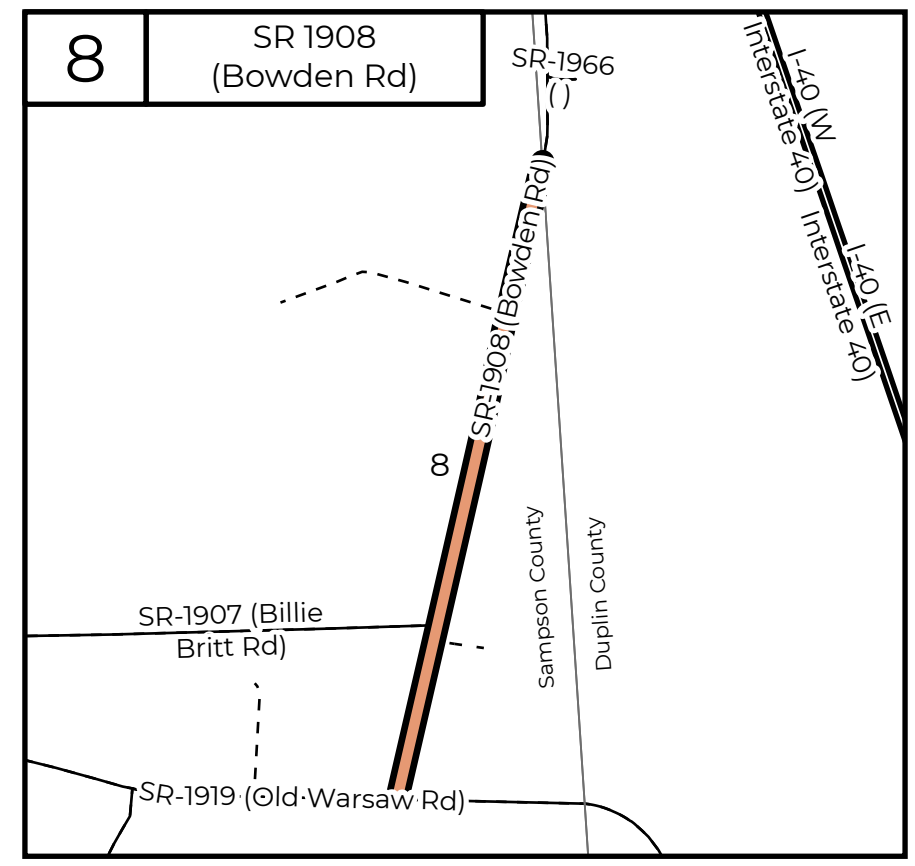
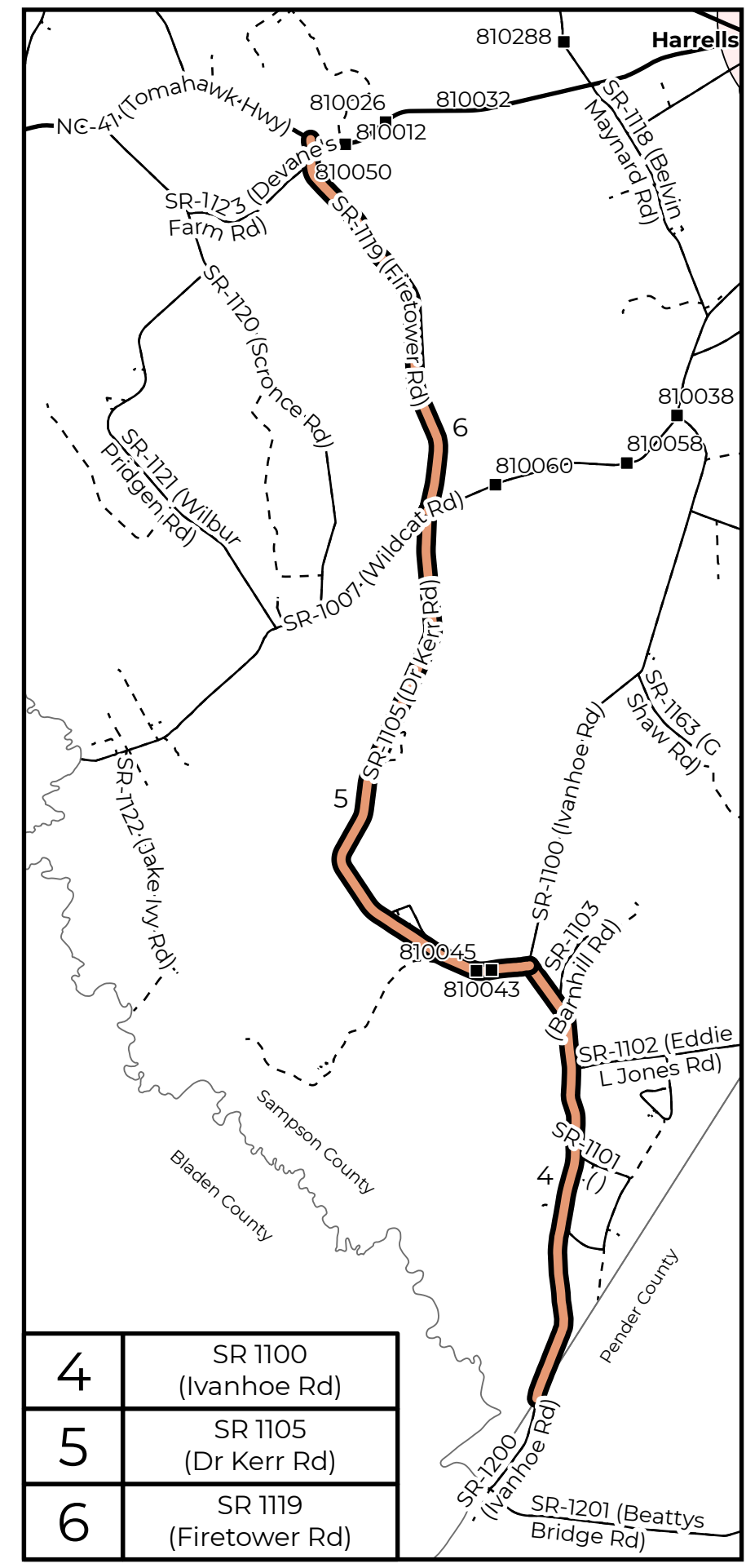
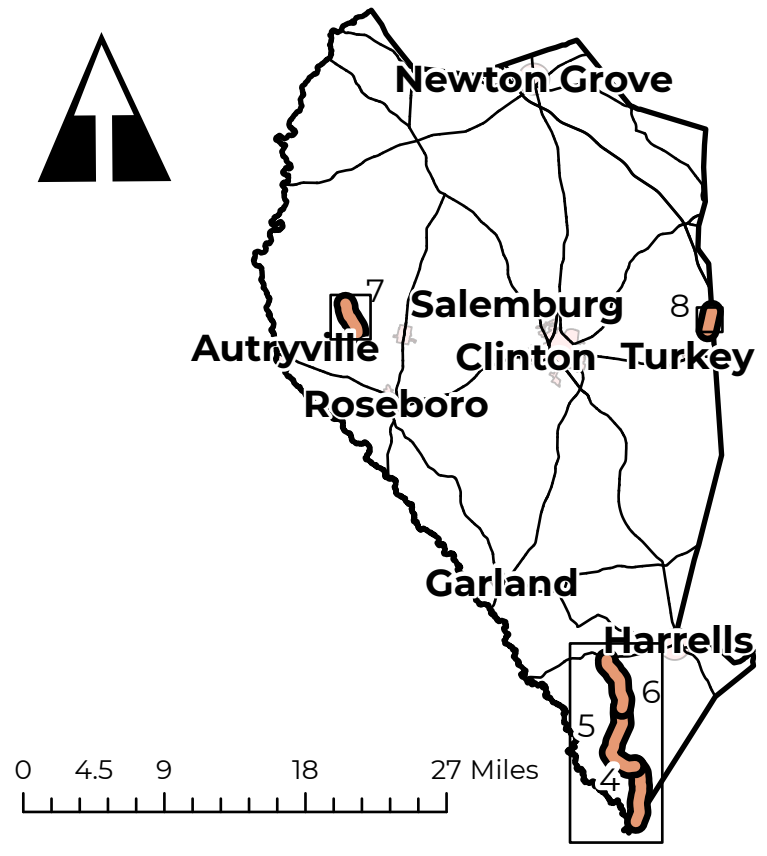

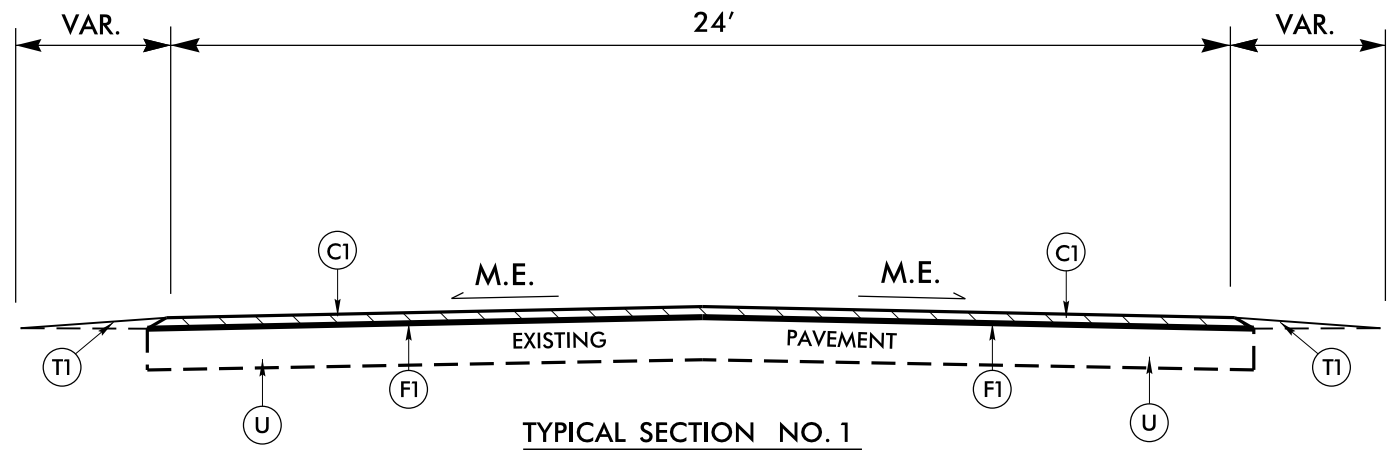

TYPICAL SECTION NO. 1

MAP NO. 1
NC 903 (EAST MAGNOLIA - LISBON RD.)
MP 7.17 - MP 9.82

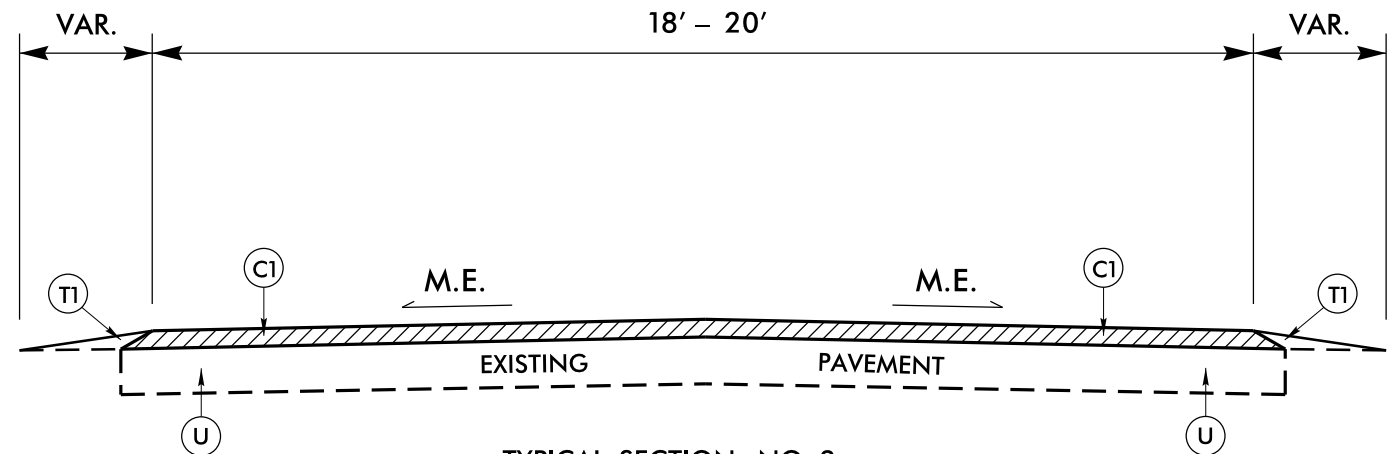

TYPICAL SECTION NO. 2

MAP NO. 2
SR 1737 (CARR CHURCH RD.)
MP 0.00 - MP 2.15

MAP NO. 3
SR 1932 (REEDSFORD RD.)
MP 0.00 - MP 1.47

MAP NO. 7
SR 1406 (JOSH SESSOMS RD.)
MP 0.00 - MP 2.04

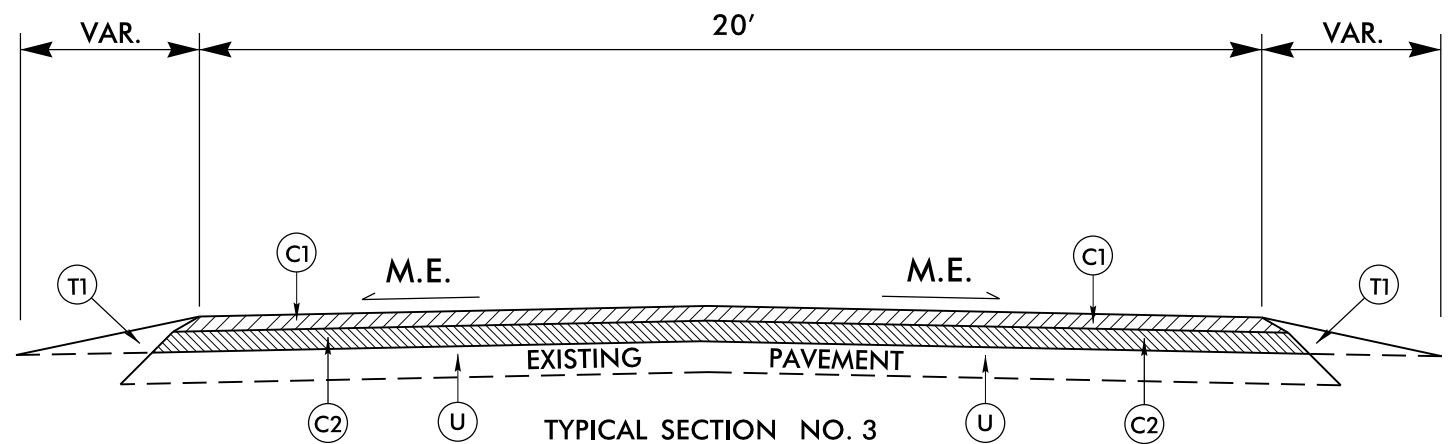

TYPICAL SECTION NO. 3

MAP NO. 8
SR 1908 (BOWDEN RD.)
MP 0.00 - MP 1.63

PAVEMENT SCHEDULE	
C1	PROP. APPROX. 1½" DEPTH ASPHALT CONCRETE SURFACE COURSE, TYPE S9.5B, AT AN AVERAGE RATE OF 165 LBS. PER SQ.YD.
C2	PROP. APPROX. 1" DEPTH ASPHALT CONCRETE SURFACE COURSE, TYPE S4.75A, AT AN AVERAGE RATE OF 110.0 LBS. PER SQ.YD.
E1	PROP. APPROX. 4" DEPTH ASPHALT CONCRETE SURFACE COURSE, TYPE B25.0C, AT AN AVERAGE RATE OF 456 LBS. PER SQ.YD.
F1	ASPHALT SURFACE TREATMENT - #67 MAT COAT (GRANITE STONE)
T1	EARTH MATERIAL (SHOULDER RECONSTRUCTION)
U	EXISTING PAVEMENT
V1	MILLING ASPHALT PAVEMENT, 1½" DEPTH

SHOULDER WORK ON MAP NO.1 - 3, 7, & 8 AS NEEDED, TO BE DETERMINED BY ENGINEER.

PAVEMENT EDGE SLOPES ARE 1:1, EXCEPT FINAL SURFACE COURSE. SEE SHOULDER WEDGE DETAIL.

REVISIONS

19-AUG-2021 16:32
 S:\Division\Resurfacing\Resurfacing Data\2021\Resurfacing\SAMPSON\FALL LET\2021CPT.03.27.10821_Rdy_tup.dgn
 8/17/99

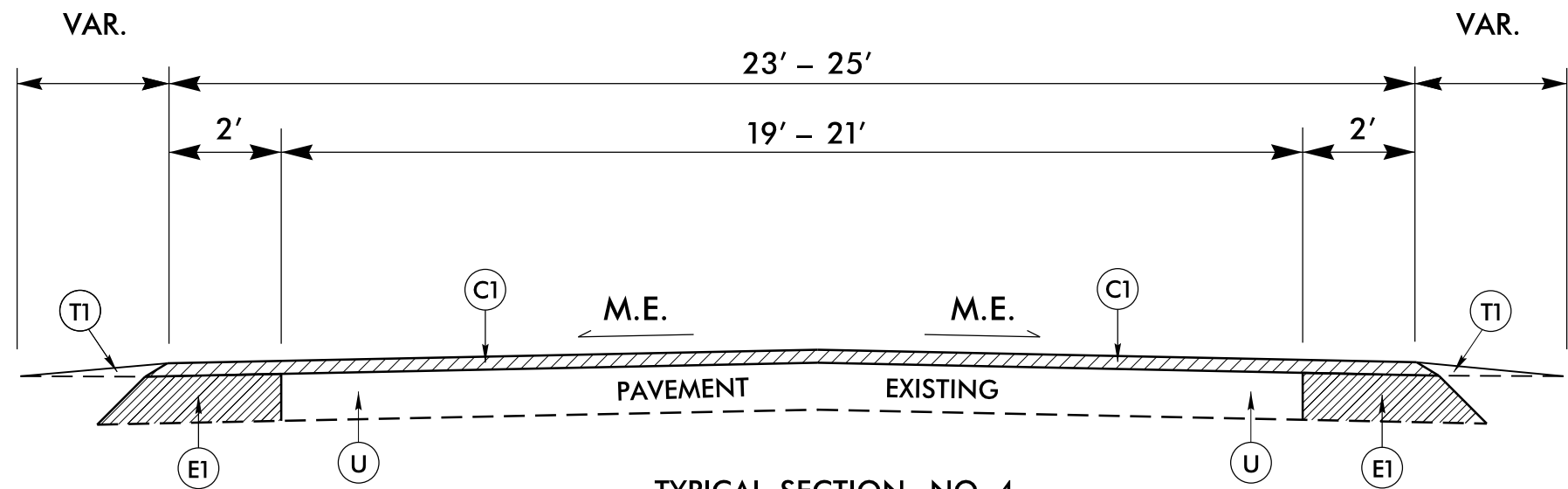

TYPICAL SECTION NO. 4

MAP NO. 4
SR 1100 (IVANHOE RD.)
MP 4.94 – MP 8.65

MAP NO. 5
SR 1105 (DOCTOR KERR RD.)
MP 0.00 – MP 4.94

MAP NO. 6
SR 1119 (FIRETOWER RD.)
MP 0.00 – MP 3.38

Ⓥ *FRIS MILL 1-1/2"
MP 4.27 – MP 4.94

Ⓥ *FRIS MILL 1-1/2"
MP 3.24 – MP 3.38

PAVEMENT SCHEDULE	
C1	1 1/2" S9.5B
E1	4" B25.0C
T1	EARTH MATERIAL (SH. RECONSTR.)
U	EXISTING PAVEMENT
V1	MILLING 1 1/2" DEPTH

PAVEMENT EDGE SLOPES ARE 1:1, EXCEPT FINAL SURFACE COURSE. SEE SHOULDER WEDGE DETAIL.

NOTES: MILL A SINGLE LANE AND PAVE BACK BY THE END OF EACH WORK DAY.

REVISIONS

19-AUG-2021 16:34
 S:\Division\Resurfacing\Resurfacing Data\2021\Resurfacing\SAMPSON\FALL LET\2021CPT.03.27.10821_Rdy_typ.dgn
 8/17/99

DETAILS OF REPAIRING EXISTING PAVEMENT PRIOR TO RESURFACING FOR FULL DEPTH AND MILLING

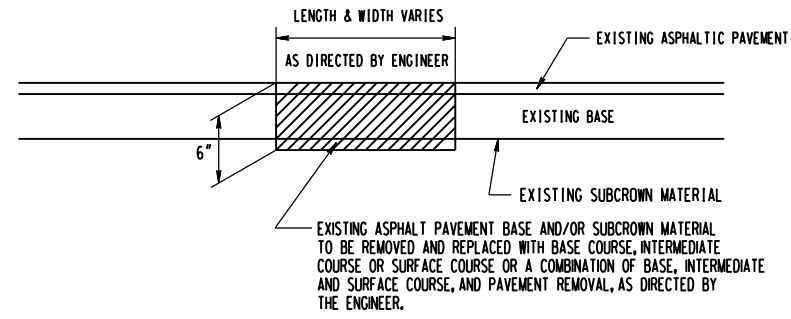

DETAIL NO. 1

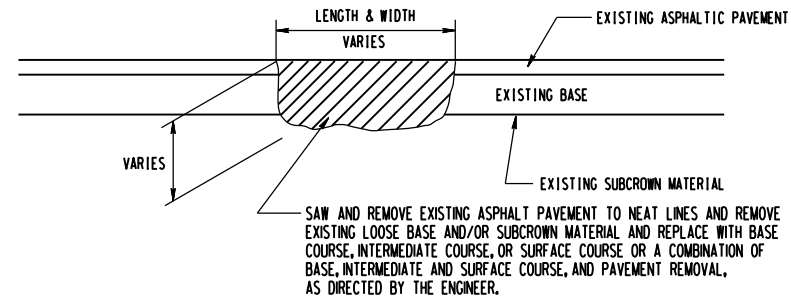

DETAIL NO. 2

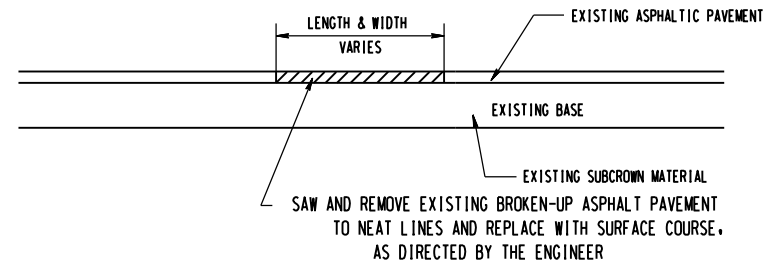

DETAIL NO. 3

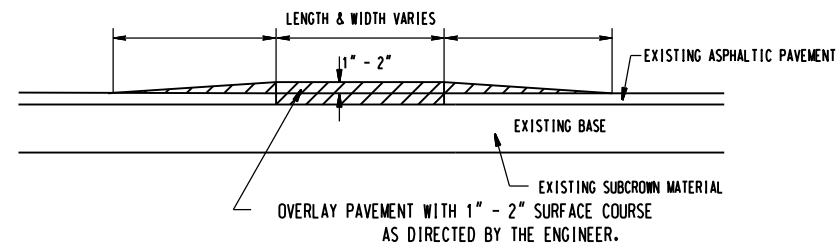

DETAIL NO. 4

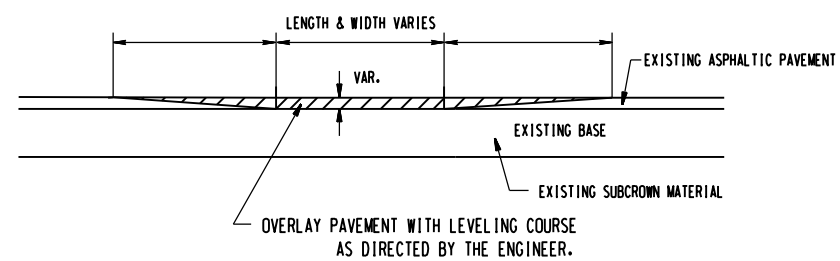

DETAIL NO. 5

REVISIONS

20-APP-2015-1156
 C:\Users\jmkim\OneDrive\Desktop\DETAIL_PSHS\Microsoft\Station Files\3CR\20711173_Patch.dgn
 \$\$\$SUSFRNME\$\$\$

- NOTES:
- 1) DETAIL DOES NOT APPLY TO OGAFC AND ULTRA-THIN BONDED WEARING COURSE.
 - 2) BACKFILL SHOULDER WITH APPROVED MATERIAL.
 - 3) THE SHOULDER WEDGE DEVICE MAY BE DISENGAGED AT PAVED DRIVEWAYS, SIDE STREETS, HIGH SHOULDERS, AND OTHER LOCATIONS NOT FEASIBLE TO CONSTRUCT AS APPROVED BY THE ENGINEER.

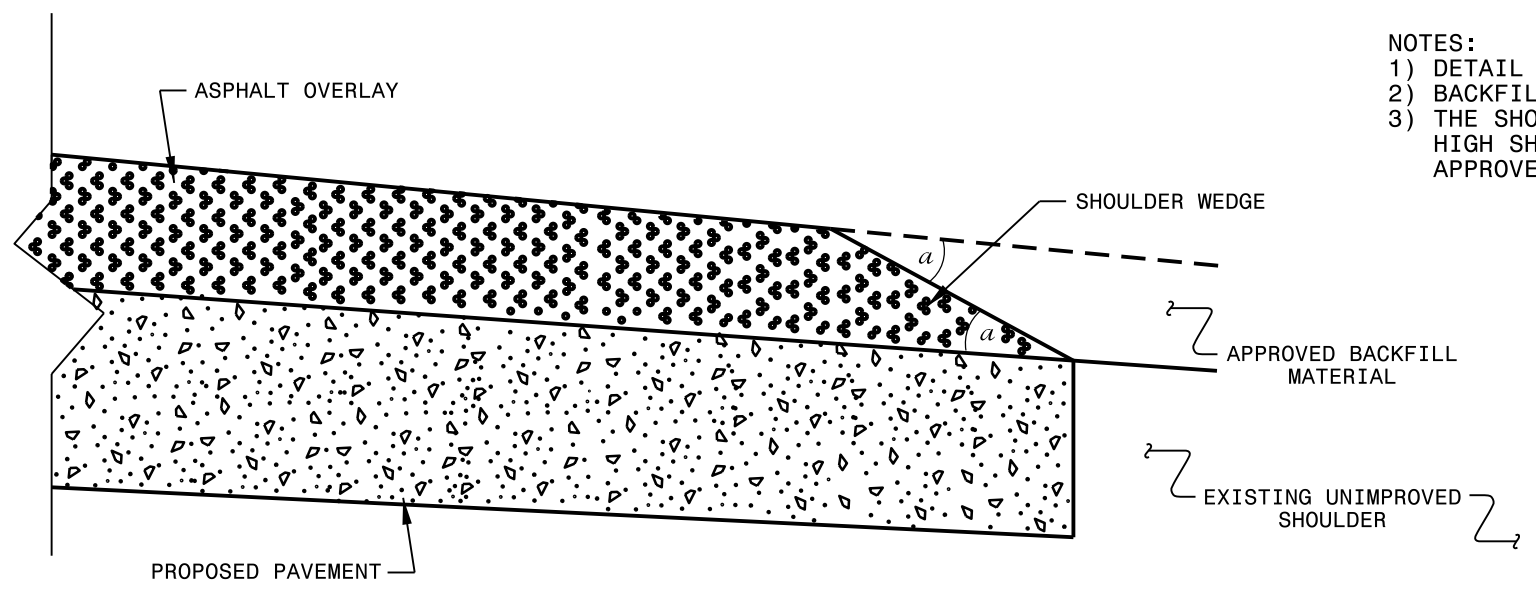

SHOULDER WEDGE DETAIL
 (Resurfacing Projects w/ Widening or
 with Existing Paved Shoulder having no dropoffs)

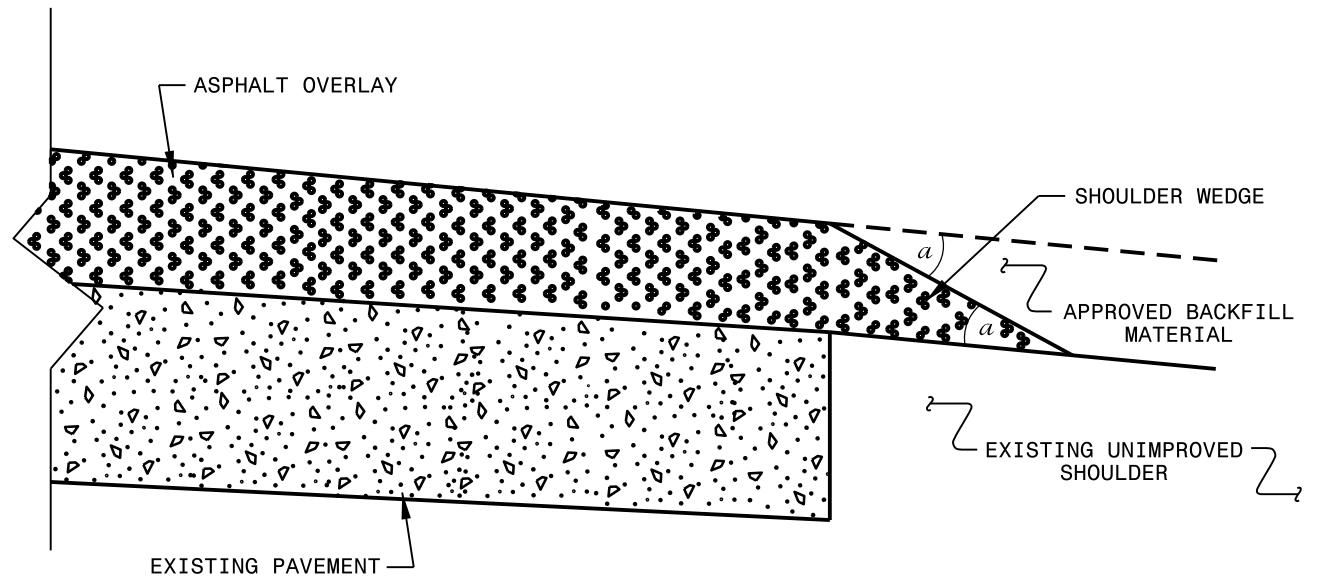

SHOULDER WEDGE DETAIL
 (Resurfacing Projects w/ NO Widening)

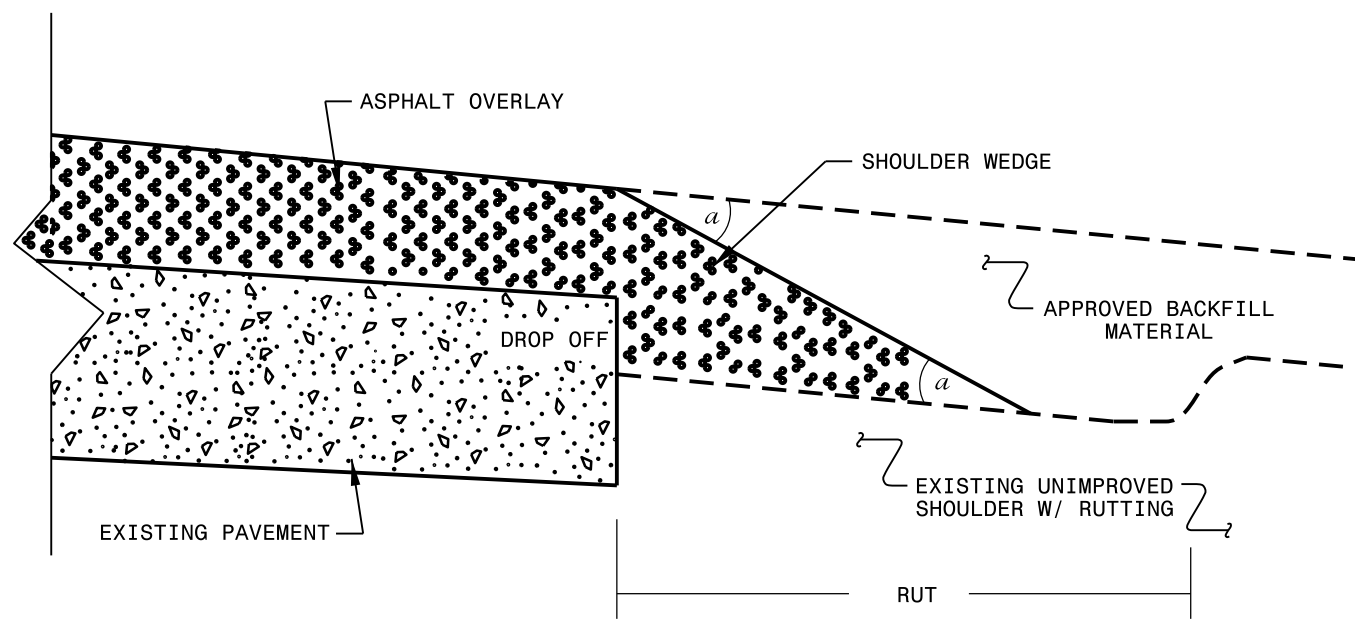

SHOULDER WEDGE DETAIL
 (Resurfacing Adjacent to
 Rutted Shoulder)

- SHOULDER WEDGE ANGLE = 30°

CONTRACT STANDARDS AND DEVELOPMENT UNIT			
Office 919-707-6950		FAX 919-250-4119	
SHOULDER WEDGE DETAILS			
ORIGINAL BY: T.SPELL	DATE: 7-19-11		
MODIFIED BY:	DATE: 2/2/16		
CHECKED BY:	DATE:		
FILE SPEC.: s:\usr\details\stand\shoulderwedgedetail.dgn			

27 JUN 2018 13:22
 s:\usr\details\stand\shoulderwedgedetail.dgn
 3\Sampson August 2018 Revised Shoulder Wedge Detail.dgn
 2021CPT.03.27.10821, Etc.

DIVISION OF HIGHWAYS
STATE OF NORTH CAROLINA

SOIL STABILIZATION TIMEFRAMES

<i>SITE DESCRIPTION</i>	<i>STABILIZATION TIME</i>	<i>TIMEFRAME EXCEPTIONS</i>
PERIMETER DIKES, SWALES, DITCHES AND SLOPES	7 DAYS	NONE
HIGH QUALITY WATER (HQW) ZONES	7 DAYS	NONE
SLOPES STEEPER THAN 3:1	7 DAYS	IF SLOPES ARE 10' OR LESS IN LENGTH AND ARE NOT STEEPER THAN 2:1, 14 DAYS ARE ALLOWED.
SLOPES 3:1 OR FLATTER	14 DAYS	7 DAYS FOR SLOPES GREATER THAN 50' IN LENGTH.
ALL OTHER AREAS WITH SLOPES FLATTER THAN 4:1	14 DAYS	NONE, EXCEPT FOR PERIMETERS AND HQW ZONES.

NOTES: Less than 5' - 10' undisturbed buffer from ROW, ditchline, water feature, or drainage inlet, add BMP.

BMP Options: Wattle or Silt Fence

EROSION CONTROL DETAIL

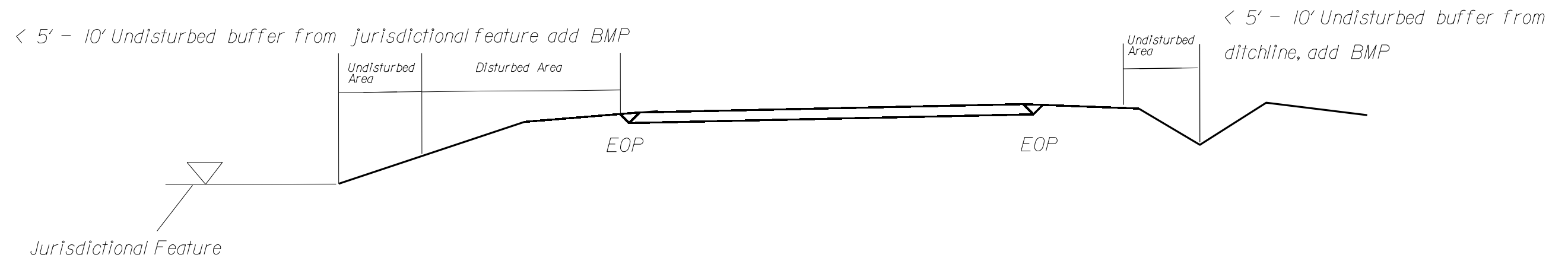
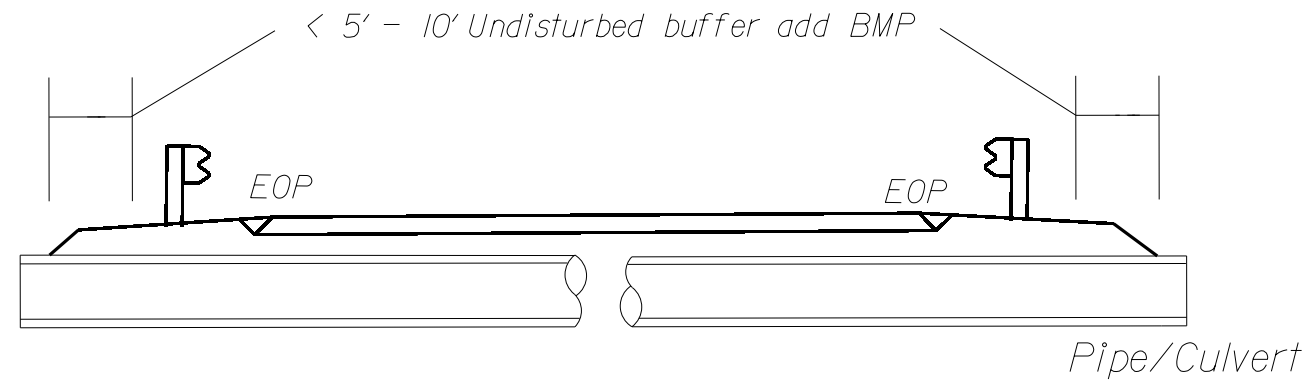

Use BMP's if shoulders and/or frontslopes and/or ditchline and/or backslopes are disturbed



< 5' - 10' Undisturbed buffer from inlet, add wattle

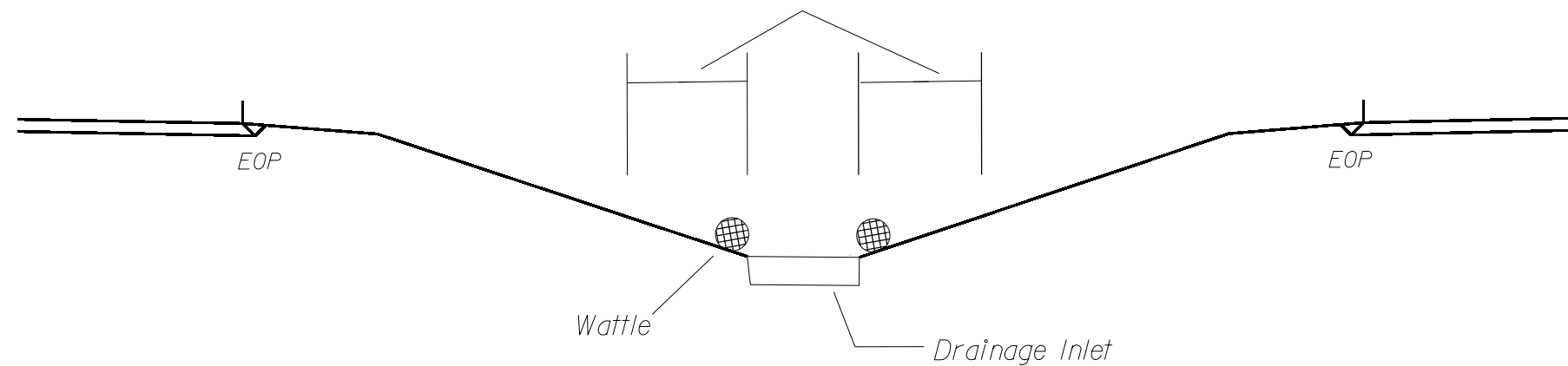

NOT TO SCALE

WATTLE DETAIL

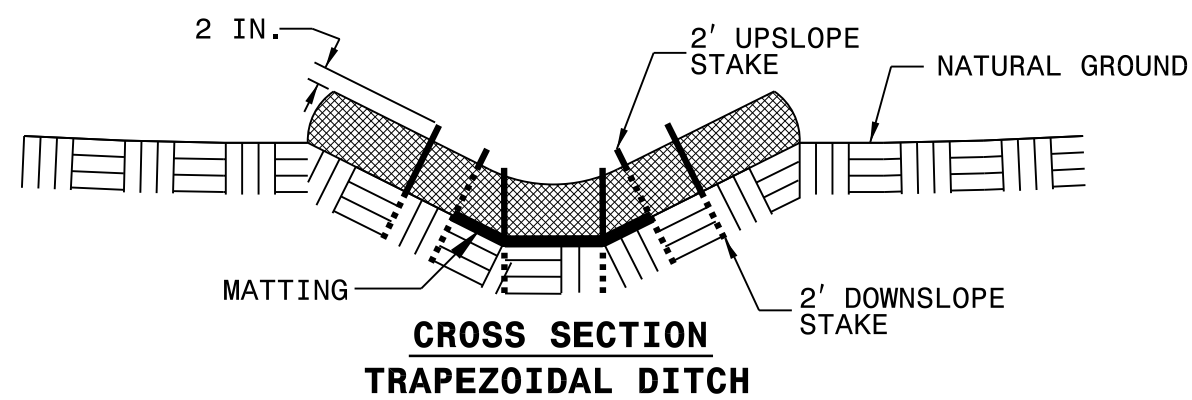
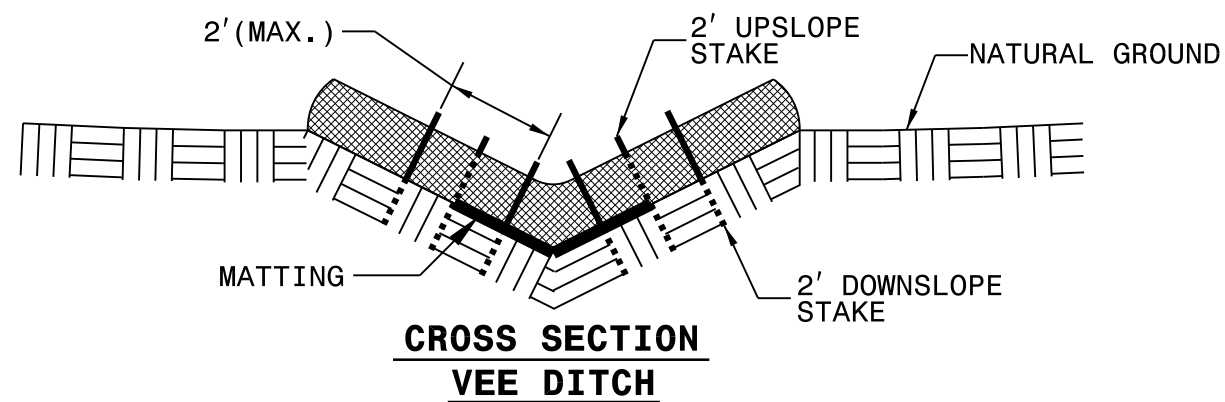
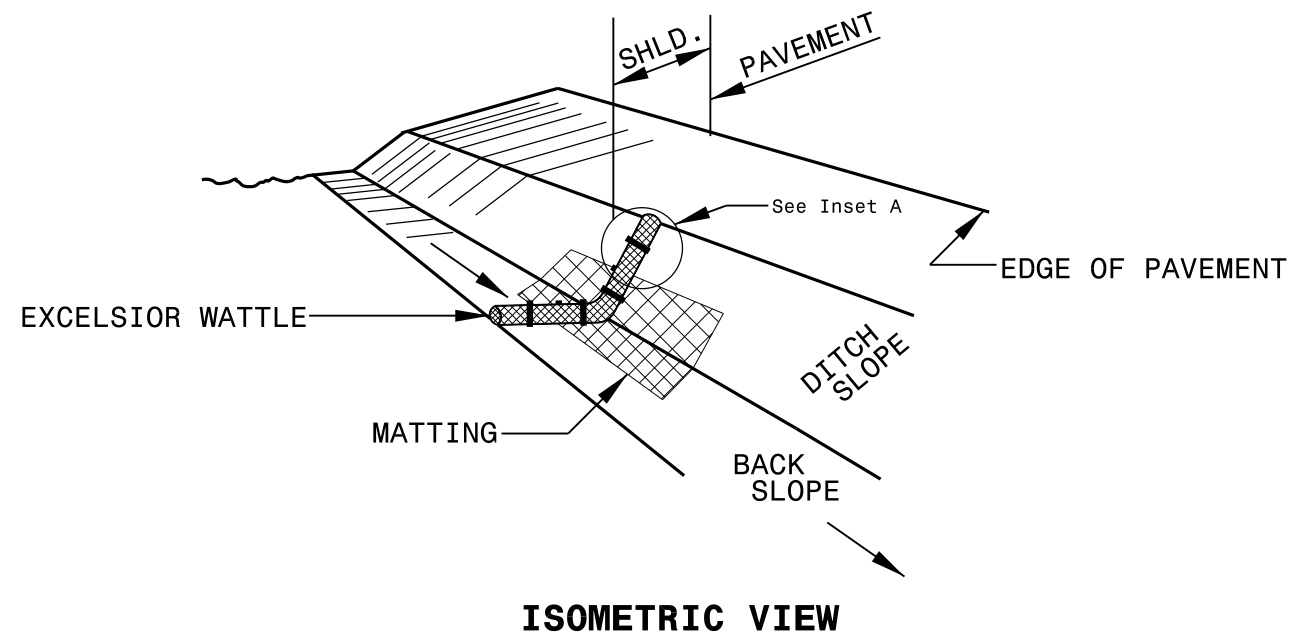

NOTES:

USE MINIMUM 12 IN. DIAMETER EXCELSIOR WATTLE.

USE 2 FT. WOODEN STAKES WITH A 2 IN. BY 2 IN. NOMINAL CROSS SECTION.

ONLY INSTALL WATTLE(S) TO A HEIGHT IN DITCH SO FLOW WILL NOT WASH AROUND WATTLE AND SCOUR DITCH SLOPES AND AS DIRECTED.

INSTALL A MINIMUM OF 2 UPSLOPE STAKES AND 4 DOWNSLOPE STAKES AT AN ANGLE TO WEDGE WATTLE TO BOTTOM OF DITCH.

PROVIDE STAPLES MADE OF 0.125 IN. DIAMETER STEEL WIRE FORMED INTO A U SHAPE NOT LESS THAN 12" IN LENGTH.

INSTALL STAPLES APPROXIMATELY EVERY 1 LINEAR FOOT ON BOTH SIDES OF WATTLE AND AT EACH END TO SECURE IT TO THE SOIL.

INSTALL MATTING IN ACCORDANCE WITH SECTION 1631 OF THE STANDARD SPECIFICATIONS.

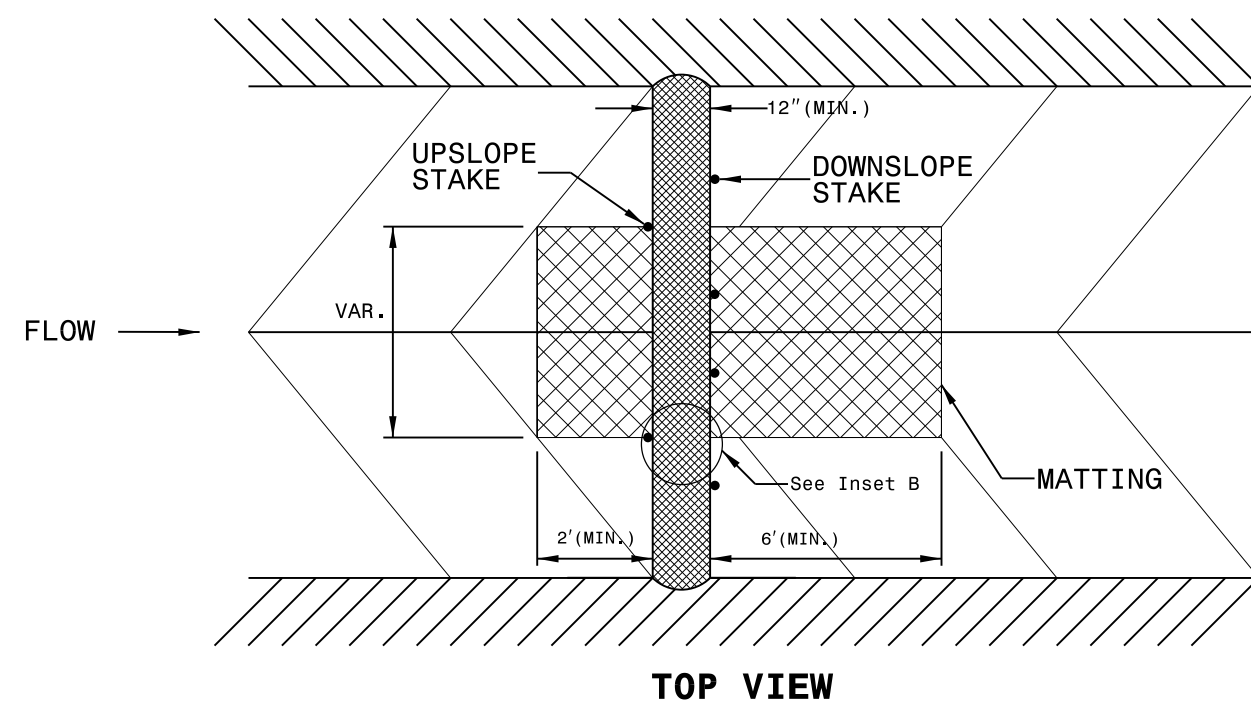
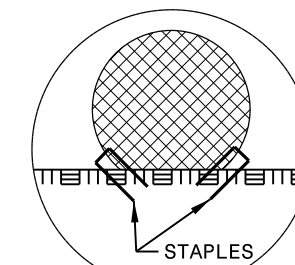
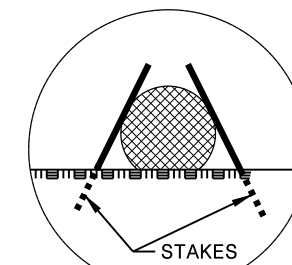

I:\FEB-2015\1141\01\Resurfacing\Plan_Sheets\3CR.20711.173. EC RESURF. 2015.dgn

PROJECT NO.	SHEET NO.
2021CPT.03.27.10821, Etc.	7

SUMMARY OF QUANTITIES

PROJECT NO	COUNTY	MAP NO	ROUTE	DESCRIPTION	TYP NO	LANES	LANE TYPE	FINAL SURFACE TESTING REQUIRED	WARM MIX ASPHALT REQUIRED	LENGTH	WIDTH	0106000000-E	1220000000-E	1245000000-E	1297000000-E	1330000000-E	1491000000-E	1519000000-E	1520000000-E	1526000000-E	1575000000-E	1775500000-E		
												BORROW EXCAVATION	INCIDENTAL STONE BASE	SHOULDER RECONSTRUCTION	1.5" MILLING	INCIDENTAL MILLING	BASE COURSE, B25.0C	SURFACE COURSE, S9.5B	LEVELING COURSE, S9.5B	SURFACE COURSE, S4.75A	ASPHALT BINDER FOR PLANT MIX	ASPHALT SURFACE TREATMENT, MATCOAT, #67 GRANITE		
												MI	FT	CY	TON	SMI	SY	SY	TONS	TON	TON	TON	TON	SY
2021CPT.03.27.10821	Sampson	1	NC 903 (EAST MAGNOLIA-LISBON ROAD)	FROM US 421 (DELWAY HWY.) TO DUPLIN COUNTY LINE [MP 7.17 - MP 9.82]	1	2	2WU	NO	NO	2.65	24	405	60	5.30		487		3,249	150		228	37,312		
TOTAL FOR MAP NO. 1												2.65		405	60	5.30		487		3,249	150		228	37,312
TOTAL FOR PROJ NO. 2021CPT.03.27.10821												2.65		405	60	5.30		487		3,249	150		228	37,312
2021CPT.03.27.20821	Sampson	2	SR 1737 (CARR CHURCH ROAD)	FROM US 701 (HOBBDON HWY.) TO SR 1740 (W. DARDEN RD.) [MP 0.00 - MP 2.15]	2	2	2WU	NO	NO	2.15	18	328	100	4.30		200		1,886			126			
TOTAL FOR MAP NO. 2												2.15		328	100	4.30		200		1,886			126	
2021CPT.03.27.20821	Sampson	3	SR 1932 (REEDSFORD ROAD)	FROM SR 1924 (ROWAN RD.) TO SR 1934 (BYRD YANCEY BASS RD.) [MP 0.00 - MP 1.47]	2	2	2WU	NO	NO	1.47	19	490	174	2.94		635		1,508			101			
TOTAL FOR MAP NO. 3												1.47		490	174	2.94		635		1,508			101	
2021CPT.03.27.20821	Sampson	4	SR 1100 (IVANHOE ROAD)	FROM SR 1105 (DR. KERR RD.) TO PENDER CO. LINE [MP 4.94 - MP 8.65]	4	2	2WU	NO	NO	3.71	24	567	116	7.42		453	2,025	3,761			343			
TOTAL FOR MAP NO. 4												3.71		567	116	7.42		453	2,025	3,761			343	
2021CPT.03.27.20821	Sampson	5	SR 1105 (DOCTOR KERR ROAD)	FROM SR 1100 (IVANHOE RD.) TO SR 1007 (WILDCAT RD.) [MP 0.00 - MP 4.94]	4	2	2WU	NO	NO	4.94	25	755	128	9.88	8,378	1,219	2,696	5,051			460			
TOTAL FOR MAP NO. 5												4.94		755	128	9.88	8,378	1,219	2,696	5,051			460	
2021CPT.03.27.20821	Sampson	6	SR 1119 (FIRETOWER ROAD)	FROM NC 41 (TOMAHAWK HWY.) TO SR 1007 (WILDCAT RD.) [MP 0.00 - MP 3.38]	4	2	2WU	NO	NO	3.38	23	516	128	6.76	1,561	106	1,845	3,129			293			
TOTAL FOR MAP NO. 6												3.38		516	128	6.76	1,561	106	1,845	3,129			293	
2021CPT.03.27.20821	Sampson	7	SR 1406 (JOSH SESSOMS ROAD)	FROM SR 1414 (MINNIE HALL RD.) TO SR 1233 (AUTRYVILLE RD.) [MP 0.00 - MP 2.04]	2	2	2WU	NO	NO	2.04	20	312	90	4.08		223		1,987			133			
TOTAL FOR MAP NO. 7												2.04		312	90	4.08		223		1,987			133	
2021CPT.03.27.20821	Sampson	8	SR 1908 (BOWDEN ROAD)	FROM SR 1413 (POPE WRAY RD.) TO SR 1919 (OLD WARSAW RD.) [MP 0.00 - MP 1.63]	3	2	2WU	NO	NO	1.63	20	249	50	3.26		338		1,622		1,085	185			
TOTAL FOR MAP NO. 8												1.63		249	50	3.26		338		1,622		1,085	185	
TOTAL FOR PROJ NO. 2021CPT.03.27.20821												19.32		3,217	786	38.64	9,939	3,174	6,566	18,944		1,085	1,641	
GRAND TOTAL												21.97		3,622	846	43.94	9,939	3,661	6,566	22,193	150	1,085	1,869	37,312

PROJECT NO.	SHEET NO.
2021CPT.03.27.10821, Etc.	8

SUMMARY OF QUANTITIES

PROJECT NO	COUNTY	MAP NO	ROUTE	DESCRIPTION	TYP NO	LANES	LANE TYPE	FINAL SURFACE TESTING REQUIRED	WARM MIX ASPHALT REQUIRED	LENGTH	WIDTH	1838000000-E	1880000000-E	6000000000-E	6009000000-E	6012000000-E	6015000000-E	6018000000-E	6021000000-E	6036000000-E	6042000000-E			
												EMULSION FOR ASPHALT SURFACE TREATMENT	PATCHING EXISTING PAVEMENT (MILL) GENERIC	PATCHING EXISTING PAVEMENT (FULL DEPTH) GENERIC	TEMPORARY SILT FENCE	STONE FOR EC CLASS B	SEDIMENT CONTROL STONE	TEMPORARY MULCHING	SEED FOR TEMPORARY SEEDING	FERTILIZER FOR TEMPORARY SEEDING	MATTING FOR EROSION CONTROL	1/4" HARDWARE CLOTH		
												MI	FT	GAL	TON	TON	LF	TON	TON	ACR	LBS	TON	SY	LF
2021CPT.03.27.10821	Sampson	1	NC 903 (EAST MAGNOLIA-LISBON ROAD)	FROM US 421 (DELWAY HWY.) TO DUPLIN COUNTY LINE [MP 7.17 - MP 9.82]	1	2	2WU	NO	NO	2.65	24	14,925	100	80	265	66	66	2.65	133	1.32	20	133		
TOTAL FOR MAP NO. 1												2.65		14,925	100	80	265	66	66	2.65	133	1.32	20	133
TOTAL FOR PROJ NO. 2021CPT.03.27.10821												2.65		14,925	100	80	265	66	66	2.65	133	1.32	20	133
												180												
2021CPT.03.27.20821	Sampson	2	SR 1737 (CARR CHURCH ROAD)	FROM US 701 (HOBBDON HWY.) TO SR 1740 (W. DARDEN RD.) [MP 0.00 - MP 2.15]	2	2	2WU	NO	NO	2.15	18		150		215	54	54	2.15	108	0.54	20	108		
TOTAL FOR MAP NO. 2												2.15			150		215	54	54	2.15	108	0.54	20	108
2021CPT.03.27.20821	Sampson	3	SR 1932 (REEDSFORD ROAD)	FROM SR 1924 (ROWAN RD.) TO SR 1934 (BYRD YANCEY BASS RD.) [MP 0.00 - MP 1.47]	2	2	2WU	NO	NO	1.47	19		50		321	80	80	3.21	161	0.80	20	161		
TOTAL FOR MAP NO. 3												1.47			50		321	80	80	3.21	161	0.80	20	161
2021CPT.03.27.20821	Sampson	4	SR 1100 (IVANHOE ROAD)	FROM SR 1105 (DR. KERR RD.) TO PENDER CO. LINE [MP 4.94 - MP 8.65]	4	2	2WU	NO	NO	3.71	24		20		371	93	93	3.71	186	0.93	30	186		
TOTAL FOR MAP NO. 4												3.71			20		371	93	93	3.71	186	0.93	30	186
2021CPT.03.27.20821	Sampson	5	SR 1105 (DOCTOR KERR ROAD)	FROM SR 1100 (IVANHOE RD.) TO SR 1007 (WILDCAT RD.) [MP 0.00 - MP 4.94]	4	2	2WU	NO	NO	4.94	25		100		494	124	124	4.94	247	1.24	40	247		
TOTAL FOR MAP NO. 5												4.94			100		494	124	124	4.94	247	1.24	40	247
2021CPT.03.27.20821	Sampson	6	SR 1119 (FIRETOWER ROAD)	FROM NC 41 (TOMAHAWK HWY.) TO SR 1007 (WILDCAT RD.) [MP 0.00 - MP 3.38]	4	2	2WU	NO	NO	3.38	23		50		338	85	85	3.38	169	0.85	30	169		
TOTAL FOR MAP NO. 6												3.38			50		338	85	85	3.38	169	0.85	30	169
2021CPT.03.27.20821	Sampson	7	SR 1406 (JOSH SESSOMS ROAD)	FROM SR 1414 (MINNIE HALL RD.) TO SR 1233 (AUTRYVILLE RD.) [MP 0.00 - MP 2.04]	2	2	2WU	NO	NO	2.04	20		50		204	51	51	2.04	102	0.51	20	102		
TOTAL FOR MAP NO. 7												2.04			50		204	51	51	2.04	102	0.51	20	102
2021CPT.03.27.20821	Sampson	8	SR 1908 (BOWDEN ROAD)	FROM SR 1413 (POPE WRAY RD.) TO SR 1919 (OLD WARSAW RD.) [MP 0.00 - MP 1.63]	3	2	2WU	NO	NO	1.63	20		450		163	41	41	1.63	82	0.41	20	82		
TOTAL FOR MAP NO. 8												1.63			450		163	41	41	1.63	82	0.41	20	82
TOTAL FOR PROJ NO. 2021CPT.03.27.20821												19.32			870		2,106	528	528	21.06	1,055	5.28	180	1,055
												870												
GRAND TOTAL												21.97		14,925	970	80	2,371	594	594	23.71	1,188	6.60	200	1,188
												1,050												

PROJECT NO.	SHEET NO.
2021CPT.03.27.10821, Etc.	9

SUMMARY OF QUANTITIES

PROJECT NO	COUNTY	MAP NO	ROUTE	DESCRIPTION	TYP NO	LANES	LANE TYPE	FINAL SURFACE TESTING REQUIRED	WARM MIX ASPHALT REQUIRED	LENGTH	WIDTH	6071010000-E	6084000000-E	6090000000-E	6093000000-E	6117000000-N	
												WATTLE	SEED & MULCHING	SEED FOR REPAIR SEEDING	FERTILIZER FOR REPAIR SEEDING	RESPONSE FOR EROSION CONTROL	
											MI	FT	LF	AC	LB	TON	EA
2021CPT.03.27.10821	Sampson	1	NC 903 (EAST MAGNOLIA-LISBON ROAD)	FROM US 421 (DELWAY HWY.) TO DUPLIN COUNTY LINE [MP 7.17 - MP 9.82]	1	2	2WU	NO	NO	2.65	24	40	2.57	133	1.32	6	
TOTAL FOR MAP NO. 1											2.65		40	2.57	133	1.32	6
TOTAL FOR PROJ NO. 2021CPT.03.27.10821											2.65		40	2.57	133	1.32	6
2021CPT.03.27.20821	Sampson	2	SR 1737 (CARR CHURCH ROAD)	FROM US 701 (HOBBDON HWY.) TO SR 1740 (W. DARDEN RD.) [MP 0.00 - MP 2.15]	2	2	2WU	NO	NO	2.15	18	40	2.08	108	0.54	6	
TOTAL FOR MAP NO. 2											2.15		40	2.08	108	0.54	6
2021CPT.03.27.20821	Sampson	3	SR 1932 (REEDSFORD ROAD)	FROM SR 1924 (ROWAN RD.) TO SR 1934 (BYRD YANCEY BASS RD.) [MP 0.00 - MP 1.47]	2	2	2WU	NO	NO	1.47	19	50	3.11	161	0.80	4	
TOTAL FOR MAP NO. 3											1.47		50	3.11	161	0.80	4
2021CPT.03.27.20821	Sampson	4	SR 1100 (IVANHOE ROAD)	FROM SR 1105 (DR. KERR RD.) TO PENDER CO. LINE [MP 4.94 - MP 8.65]	4	2	2WU	NO	NO	3.71	24	60	3.60	186	0.63	8	
TOTAL FOR MAP NO. 4											3.71		60	3.60	186	0.63	8
2021CPT.03.27.20821	Sampson	5	SR 1105 (DOCTOR KERR ROAD)	FROM SR 1100 (IVANHOE RD.) TO SR 1007 (WILDCAT RD.) [MP 0.00 - MP 4.94]	4	2	2WU	NO	NO	4.94	25	80	4.79	247	1.24	8	
TOTAL FOR MAP NO. 5											4.94		80	4.79	247	1.24	8
2021CPT.03.27.20821	Sampson	6	SR 1119 (FIRETOWER ROAD)	FROM NC 41 (TOMAHAWK HWY.) TO SR 1007 (WILDCAT RD.) [MP 0.00 - MP 3.38]	4	2	2WU	NO	NO	3.38	23	60	3.28	169	0.85	6	
TOTAL FOR MAP NO. 6											3.38		60	3.28	169	0.85	6
2021CPT.03.27.20821	Sampson	7	SR 1406 (JOSH SESSOMS ROAD)	FROM SR 1414 (MINNIE HALL RD.) TO SR 1233 (AUTRYVILLE RD.) [MP 0.00 - MP 2.04]	2	2	2WU	NO	NO	2.04	20	40	1.98	102	0.51	4	
TOTAL FOR MAP NO. 7											2.04		40	1.98	102	0.51	4
2021CPT.03.27.20821	Sampson	8	SR 1908 (BOWDEN ROAD)	FROM SR 1413 (POPE WRAY RD.) TO SR 1919 (OLD WARSAW RD.) [MP 0.00 - MP 1.63]	3	2	2WU	NO	NO	1.63	20	30	1.58	82	0.41	4	
TOTAL FOR MAP NO. 8											1.63		30	1.58	82	0.41	4
TOTAL FOR PROJ NO. 2021CPT.03.27.20821											19.32		360	20.42	1,055	4.98	40
GRAND TOTAL											21.97		400	22.99	1,188	6.30	46

PROJECT NO.	SHEET NO.
2021CPT.03.27.10821, Etc.	10

THERMOPLASTIC AND PAINT QUANTITIES

PROJECT NO	COUNTY	MAP NO	ROUTE	DESCRIPTION	TYP NO	LANES	LANE TYPE	LENGTH	WIDTH	4413000000-E	4457000000-N	4685000000-E		4810000000-E		4835000000-E	4850000000-E	4900000000-N	4905000000-N				
										WORK ZONE ADVANCE/GENERAL WARNING SIGNING	TEMPORARY TRAFFIC CONTROL	4" X 90 M YELLOW THERMO	4" X 90 M WHITE THERMO	4" WHITE PAINT	4" YELLOW PAINT	24" WHITE PAINT	REMOVAL OF PAVEMENT MARKING LINES (4")	YELLOW & YELLOW MARKERS	SNOW PLOWABLE MARKERS (Y/Y)				
									MI	FT	SF	LS	LF	LF	LF	LF	LF	EA	EA				
2021CPT.03.27.10821	Sampson	1	NC 903 (EAST MAGNOLIA-LISBON ROAD)	FROM US 421 (DELWAY HWY.) TO DUPLIN COUNTY LINE [MP 7.17 - MP 9.82]	1	2	2WU	2.65	24	297	0.11	23,536	28,474					10	175				
TOTAL FOR MAP NO. 1									2.65		297	0.11	23,536	28,474					10	175			
TOTAL FOR PROJ NO. 2021CPT.03.27.10821									2.65		297	0.11	23,536	28,474					10	175			
												52,010											
2021CPT.03.27.20821	Sampson	2	SR 1737 (CARR CHURCH ROAD)	FROM US 701 (HOBBTON HWY.) TO SR 1740 (W. DARDEN RD.) [MP 0.00 - MP 2.15]	2	2	2WU	2.15	18	241	0.09			45,408	33,192			145					
TOTAL FOR MAP NO. 2									2.15		241	0.09			45,408	33,192			145				
2021CPT.03.27.20821	Sampson	3	SR 1932 (REEDSFORD ROAD)	FROM SR 1924 (ROWAN RD.) TO SR 1934 (BYRD YANCEY BASS RD.) [MP 0.00 - MP 1.47]	2	2	2WU	1.47	19		0.07			69,698	46,730	300		215					
TOTAL FOR MAP NO. 3									1.47			0.07			69,698	46,730	300		215				
2021CPT.03.27.20821	Sampson	4	SR 1100 (IVANHOE ROAD)	FROM SR 1105 (DR. KERR RD.) TO PENDER CO. LINE [MP 4.94 - MP 8.65]	4	2	2WU	3.71	24	416	0.17			78,356	52,636	206		245					
TOTAL FOR MAP NO. 4									3.71		416	0.17			78,356	52,636	206		245				
2021CPT.03.27.20821	Sampson	5	SR 1105 (DOCTOR KERR ROAD)	FROM SR 1100 (IVANHOE RD.) TO SR 1007 (WILDCAT RD.) [MP 0.00 - MP 4.94]	4	2	2WU	4.94	25	553	0.21			105,402	49,644	68	1,368	327					
TOTAL FOR MAP NO. 5									4.94		553	0.21			105,402	49,644	68	1,368	327				
2021CPT.03.27.20821	Sampson	6	SR 1119 (FIRETOWER ROAD)	FROM NC 41 (TOMAHAWK HWY.) TO SR 1007 (WILDCAT RD.) [MP 0.00 - MP 3.38]	4	2	2WU	3.38	23	379	0.17			70,648	44,772			224					
TOTAL FOR MAP NO. 6									3.38		379	0.17			70,648	44,772			224				
2021CPT.03.27.20821	Sampson	7	SR 1406 (JOSH SESSOMS ROAD)	FROM SR 1414 (MINNIE HALL RD.) TO SR 1233 (AUTRYVILLE RD.) [MP 0.00 - MP 2.04]	2	2	2WU	2.04	20	228	0.10			42,710	29,350	100		137					
TOTAL FOR MAP NO. 7									2.04		228	0.10			42,710	29,350	100		137				
2021CPT.03.27.20821	Sampson	8	SR 1908 (BOWDEN ROAD)	FROM SR 1413 (POPE WRAY RD.) TO SR 1919 (OLD WARSAW RD.) [MP 0.00 - MP 1.63]	3	2	2WU	1.63	20		0.08			34,494	11,506	100		108					
TOTAL FOR MAP NO. 8									1.63			0.08			34,494	11,506	100		108				
TOTAL FOR PROJ NO. 2021CPT.03.27.20821									19.32		1,817	0.89			446,716	267,830	774	1,368	1,401				
												714,546											
GRAND TOTAL									21.97		2,114	1.00	23,536	28,474	446,716	267,830	774	1,368	1,411	175			
												52,010		714,546									

SIGNING FOR RESURFACING PROJECTS

LEGEND

┆ STATIONARY SIGN

← DIRECTION OF TRAFFIC FLOW

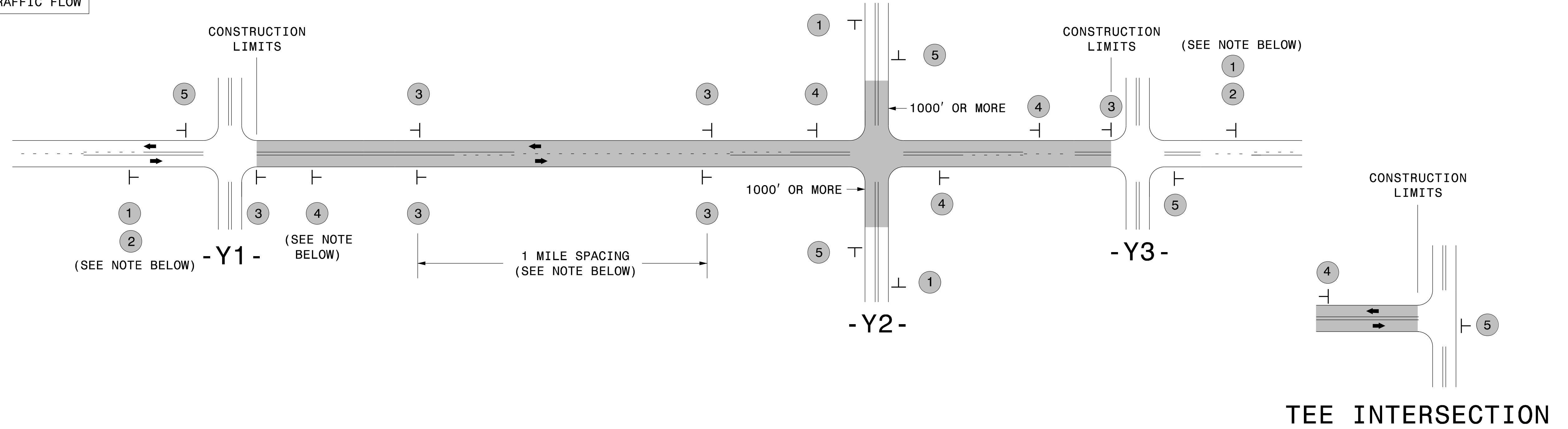

MAINLINE (-L-) SIGNING

-Y- LINE SIGNING

SIGNING NOTES AND PLACEMENT PER DIRECTION	1	 <small>W20-1 48" X 48"</small>	PLACE 1000' PRIOR TO BEGINNING OF CONSTRUCTION LIMITS. ONLY USED ON -Y- LINES IF RESURFACING LIMITS EXTEND 1000' ALONG -Y- LINE.		
	2	 <small>W7-3aP 24" X 18"</small>	#2 SIGN ONLY USED WHEN CONSTRUCTION LIMITS ARE 2 OR MORE MILES IN LENGTH. ROUND UP TO NEXT WHOLE NUMBER. (NO FRACTIONAL OR DECIMAL NUMBERS)		
	3	 <small>SP 13107 48" X 48"</small>	- PLACE INITIALLY AT THE CONSTRUCTION LIMITS AND SPACE 1 MILE APART THEREAFTER. - AT TEE INTERSECTIONS INSTALL INITIALLY 1/2 MILE FROM INTERSECTION AND SPACE 1 MILE APART THEREAFTER.		
	4	 <small>SP 13106 48" X 48"</small>	- THESE ARE FOR -Y- LINES THAT ARE "THROUGH" ROADWAYS. - DEAD END AND SUBDIVISION ROADS ARE NOT "THROUGH" ROADWAYS. - INSTALL 500' +/- FROM EACH -Y- LINE APPROACH AS SHOWN ABOVE. - FOR MULTIPLE -Y- LINES THAT ARE SEPARATED BY 0.25 MILES OR LESS, TREAT AS A SINGLE UNIT AND INSTALL WITHIN 500' OF EACH APPROACH. - A MAXIMUM OF 2 SIGN SETS PER MILE. DO NOT INSTALL WHEN -Y- LINES ARE WITHIN 0.5 MILES FROM "END ROAD WORK" SIGN. - FOR TEE INTERSECTIONS, INSTALL WITHIN 500' +/- OF THE INTERSECTION ALONG -L- LINE.		
	5	 <small>G20-2 A 48" X 24"</small>	PLACE 500' FOLLOWING THE END OF CONSTRUCTION LIMITS OR AS SHOWN WHEN WORK ENDS AT A 3-WAY TEE INTERSECTION.		

NO REQUIRED STATIONARY SIGNING FOR THE FOLLOWING -Y- LINE CONDITIONS:

- 1) LESS THAN 1000' OF RESURFACING ALONG -Y- LINE
- 2) SUBDIVISION ROADS
- 3) DEAD END ROADS

WHEN PAVING/CONSTRUCTION ACTIVITIES PROCEED ACROSS AN UNSIGNED -Y- LINE, PORTABLE ADVANCE WARNING SIGNS SHALL BE USED ALONG THE -Y- LINE AS SHOWN BELOW. REMOVE UPON COMPLETION OF WORK.

 <small>W20-1 48" X 48"</small> PLACED 500' IN ADVANCE OF FLAGGER.	 <small>W20-7 A 48" X 48"</small> PLACED 250' IN ADVANCE OF FLAGGER.
------------------------------------------------------------------------------	--------------------------------------------------------------------------------

THE ABOVE SIGNS ARE ALL THAT ARE REQUIRED FOR A CONTRACTOR TO BEGIN A RESURFACING CONTRACT. ANY ADDITIONAL SIGNS REQUESTED BY NCDOT DIVISIONS SHALL BE INSTALLED WITHIN 7 BUSINESS DAYS OF THE START OF CONTRACT WORK.

MAPS LESS THAN 2 MILES

FOR RESURFACING MAPS WITH CONSTRUCTION LIMITS LESS THAN 2 MILES IN LENGTH, NO STATIONARY SIGNS ARE REQUIRED. USE PORTABLE "ROAD UNDER CONSTRUCTION" OR "ROAD WORK AHEAD" SIGNS IN LIEU OF STATIONARY ADVANCE WARNINGS SIGNS.

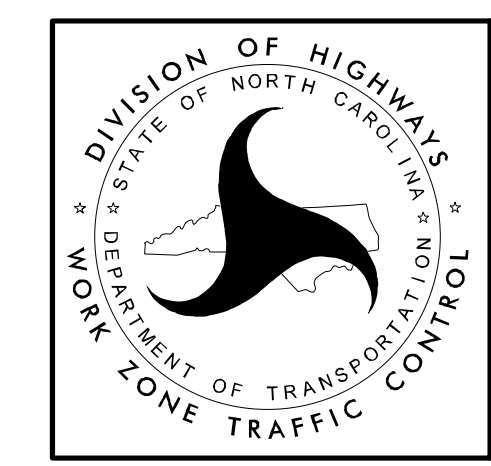

ADVANCE WARNING SIGNS FOR RURAL AND SUBURBAN 2-LANE ROADWAY RESURFACING

5/15/2017 S:\TUXWZTC\Resurfacing\2L2W & AST Resurfacing Details\Resurfacing_AdvWarn_2Ln.dgn User:kadai

SIGNING FOR ASPHALT SURFACE TREATMENT

LEGEND

- ▷ PORTABLE SIGN
- └ STATIONARY SIGN
- ← DIRECTION OF TRAFFIC FLOW

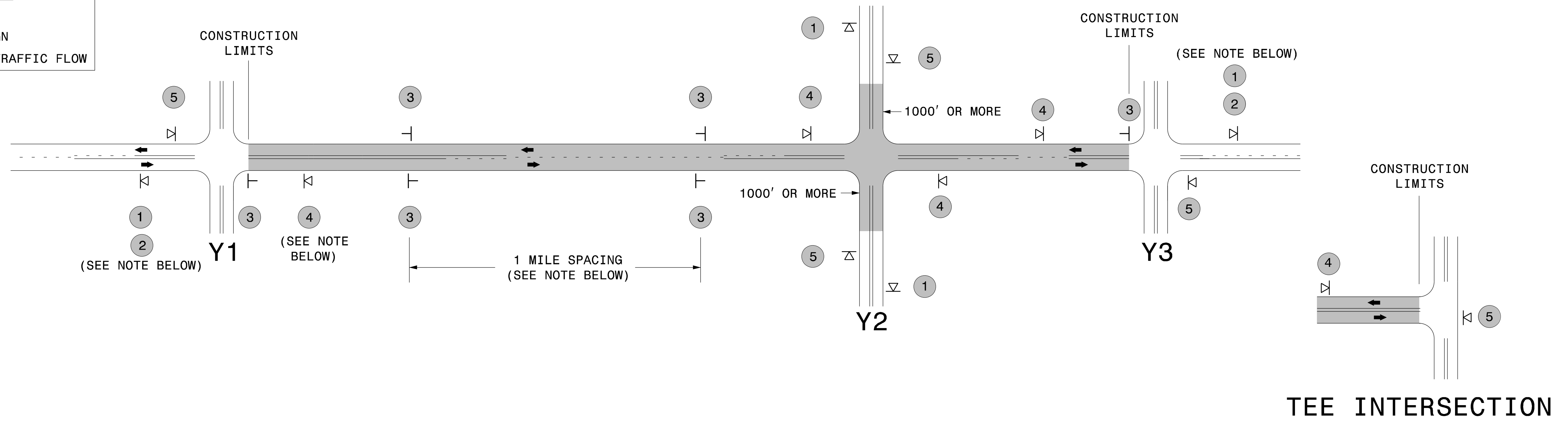

MAINLINE (-L-) SIGNING

-Y- LINE SIGNING

SIGNING NOTES AND PLACEMENT PER DIRECTION	1		- PLACE 1000' PRIOR TO BEGINNING OF CONSTRUCTION LIMITS. ONLY USED ON -Y- LINES IF RESURFACING LIMITS EXTEND 1000' ALONG -Y- LINE.	<p>STATIONARY SIGNING NOT REQUIRED FOR THE FOLLOWING -Y- LINE CONDITIONS:</p> <ol style="list-style-type: none"> 1) LESS THAN 1000' OF RESURFACING ALONG -Y- LINE 2) SUBDIVISION ROADS 3) DEAD END ROADS <p>WHEN PAVING/CONSTRUCTION ACTIVITIES PROCEED ACROSS AN UNSIGNED -Y- LINE, PORTABLE ADVANCE WARNING SIGNS SHALL BE USED ALONG THE -Y- LINE AS SHOWN BELOW. REMOVE UPON COMPLETION OF WORK.</p> <div style="display: flex; justify-content: space-around;"> <div style="text-align: center;"> W20-1 48" X 48" PLACED 500' IN ADVANCE OF FLAGGER. </div> <div style="text-align: center;"> W20-7 A 48" X 48" PLACED 250' IN ADVANCE OF FLAGGER. </div> </div>
	2		- SIGN #2 ONLY USED WHEN RESURFACING LIMITS ARE 2 OR MORE MILES IN LENGTH. ROUND UP TO THE NEAREST WHOLE NUMBER. DO NOT USE FRACTIONAL OR DECIMAL NUMBERS.	
	3	 	- ALTERNATE THE FOLLOWING TWO SIGNS: - STARTING WITH "LOOSE GRAVEL" (W8-7) FOLLOWED BY "UNMARKED PAVEMENT". - PLACE INITIALLY AT THE CONSTRUCTION LIMITS AND SPACED 1 MILE APART THEREAFTER. - AT TEE INTERSECTIONS INSTALL INITIALLY 0.5 MILE FROM INTERSECTION AND SPACE 1 MILE APART THEREAFTER.	
	4		- THESE ARE FOR -Y- LINES THAT ARE "THROUGH" ROADWAYS. DEAD END AND SUBDIVISION ROADS ARE NOT "THROUGH" ROADWAYS. - INSTALL 500' +/- FROM EACH -Y- LINE APPROACH AS SHOWN ABOVE. - FOR MULTIPLE -Y- LINES THAT ARE SEPARATED BY 0.25 MILES OR LESS, TREAT AS A SINGLE UNIT AND INSTALL WITHIN 500' OF EACH APPROACH. - A MAXIMUM OF 2 SIGN SETS PER MILE. DO NOT INSTALL WHEN -Y- LINES ARE WITHIN 0.5 MILES FROM "END ROAD WORK" SIGN.	
	5		PLACE 500' FOLLOWING THE END OF CONSTRUCTION LIMITS OR AS SHOWN WHEN WORK ENDS AT A 3-WAY TEE INTERSECTION.	

THE ABOVE SIGNS ARE ALL THAT ARE REQUIRED FOR A CONTRACTOR TO BEGIN A RESURFACING CONTRACT. ANY ADDITIONAL SIGNS REQUESTED BY NCDOT DIVISIONS SHALL BE INSTALLED WITHIN 7 BUSINESS DAYS OF THE START OF CONTRACT WORK.

MAPS LESS THAN 2 MILES

FOR AST RESURFACING MAPS WITH CONSTRUCTION LIMITS LESS THAN 2 MILES IN LENGTH, USE A STATIONARY "LOOSE GRAVEL" SIGN AT THE BEGINNING CONSTRUCTION LIMIT FOLLOWED BY AN "UNMARKED PAVEMENT" SIGN MIDWAY THROUGH AND AN "END ROAD WORK" SIGN AT THE END CONSTRUCTION LIMIT.

ADVANCE WARNING SIGNS FOR 2-LANE ROADWAY ASPHALT SURFACE TREATMENT